

Project Name: _____ Date: _____
 Location: _____
 Engineer: _____
 Contractor: _____ Rep: _____

1 – GENERAL SPECIFICATIONS

Product Features:

- VM110 SA240-S43932 Stainless Steel Heat Exchanger
- ASME "H" stamped boiler, designed and constructed in compliance with the ASME Boiler and Pressure Vessel Code Section IV
- Built-in Primary Loop
- Maximum operating pressure 30 psi [206.8 kPa]
- Modulating burner, 6.5 turndown ratio
- Direct Spark Ignition
- Wall (standard) or floor mounting (w/ opt. kit, NTI part # 84630)
- Zero clearance to combustibles
- 110 MBH [110,000 BTU]
- Field conversion from Natural Gas (factory) to Propane
- Optional Sidewall vent kits
- Built-in 3 speed circulator
- Water pressure sensor
- Vertical Firetube Boiler
- 120VAC outlet for condensate pump
- On/Off switch

Factory Supplied Items

- 10K thermistor outdoor sensor
- 30PSI [206.8 kPa] ASME Relief Valve
- 60PSI [413.7 kPa] Pressure Gauge
- Condensate Trap

Control Features

- Integral microprocessor safety control
- Domestic Hot Water Priority timer
- Outdoor Reset
- Warm weather shut down
- Freeze protection
- Cascade up to 16 VM110 series boilers
- 3 circulator outputs
- Outdoor reset temperature boost
- Compatible with indirect water heater w/ tank sensor or switch
- Service reminder
- Adjustable pump post purge
- Run time accumulation
- Night setback option
- Lockout and error history

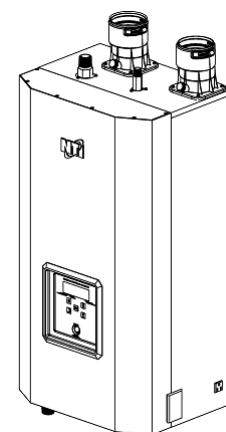
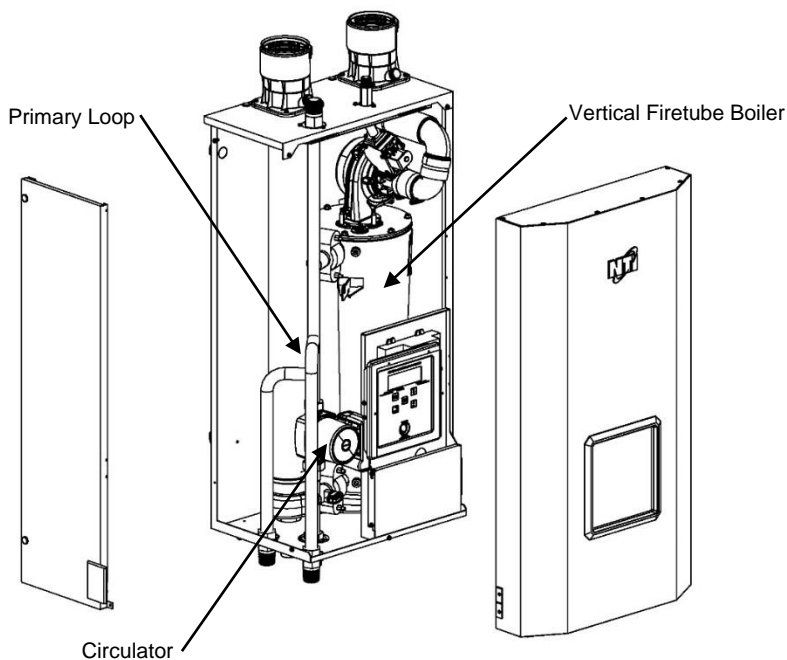

Model Specifications

Model	Water Conn. NPT, in.	Gas Connection NPT, in.	Vent/Air-Intake Pipe Diameter in.	Vent/ Air-Inlet Max. Length, Ft.		Approx. Wt. w/Water lb.
				2 in. Venting	3 in. Venting	
VM110	1 (Male)	½ (Male)	2 or 3	100	150	132
				100		

Heating Specifications

Model	Input		Heating Capacity BTU/hr	AFUE %	NET I=B=R Rating BTU/hr
	Min BTU/hr	Max BTU/hr			
VM110	17,000	110,000	101,000	95	88,000

Performance Specifications

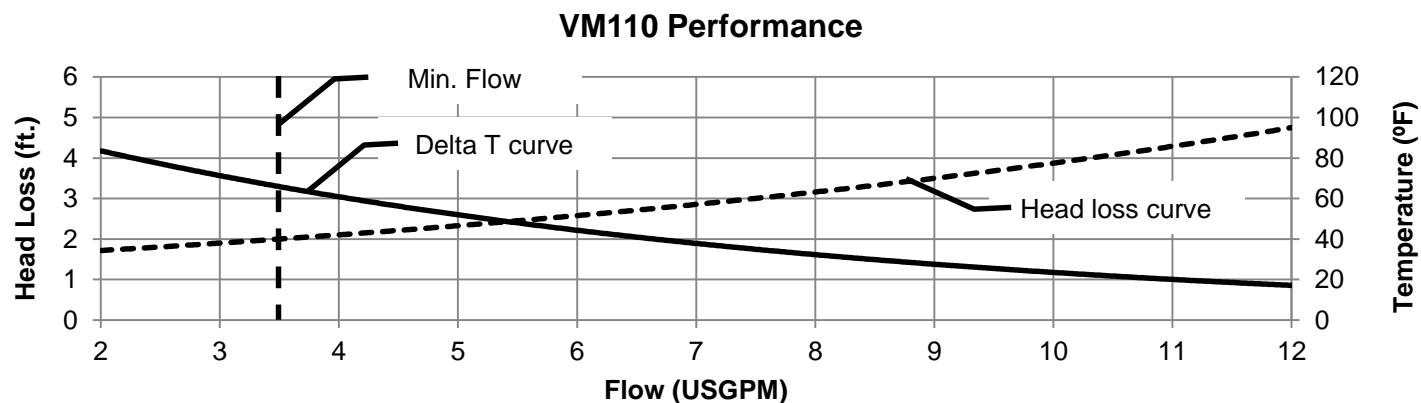

2 – PRODUCT DIMENSIONS [IN.]

TOP VIEW

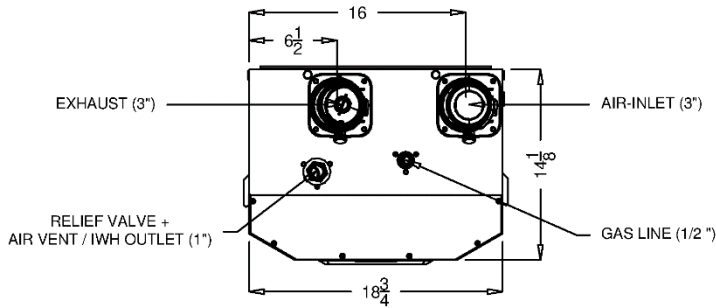

BOTTOM VIEW

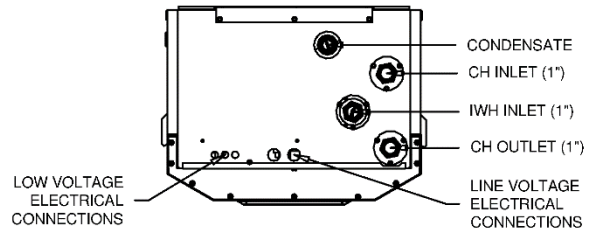

FRONT VIEW

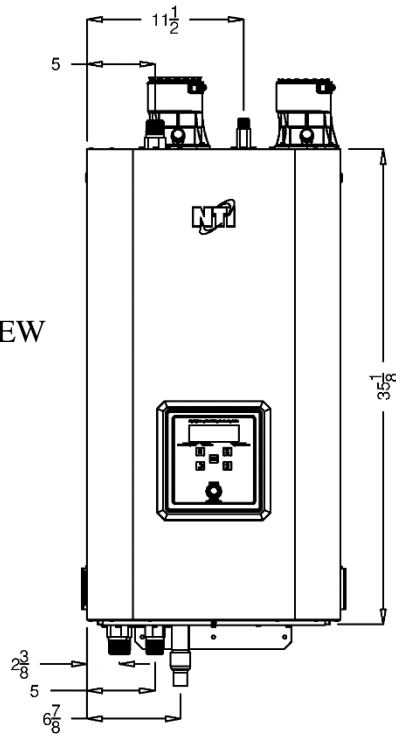

RIGHT VIEW

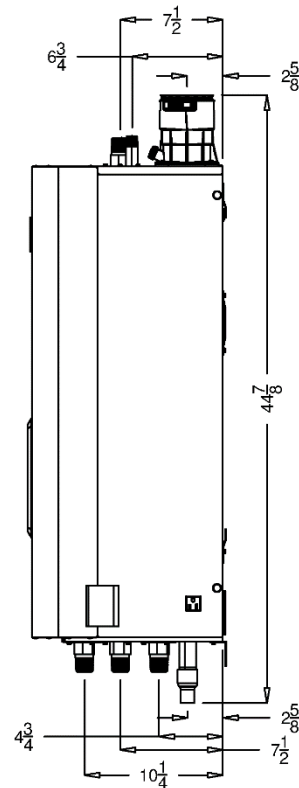

RECOMMENDED CLEARANCES [IN.]

Front	Top	Sides	Back	Bottom	Flue Pipe
36	24	12	0	24	1

3 -- FIELD WIRING

